



6/50 Rourke Lane Kensington VIC

2 2 1

With its two-storey layout, premium features, and abundant natural light, this townhouse-style apartment offers an excellent opportunity for first-time buyers, owner occupiers or a valuable addition to any investment portfolio.

Type : Unit
Price : \$550,000 to \$600,000
View : <https://www.jmre.com.au/sale/vic/north/kensington/residential/unit/8163383>

Move-in ready, the home's welcoming interior includes two upstairs bedrooms (both with mirrored wardrobes), a private master ensuite, and a main bathroom with floor-to-ceiling tiles. The versatile open-plan living and dining area connects to a well-equipped kitchen featuring tiled splashbacks, stainless-steel appliances, and a dishwasher. Additional features include a full-width undercover balcony with an elevated view, split-system heating/cooling in three zones, square-set ceilings, a large under-stair storage space, and secure undercover parking



Jmre A Smartre Agency
03 9328 2002

[For full version visit the website](https://www.jmre.com.au)



Upper Level

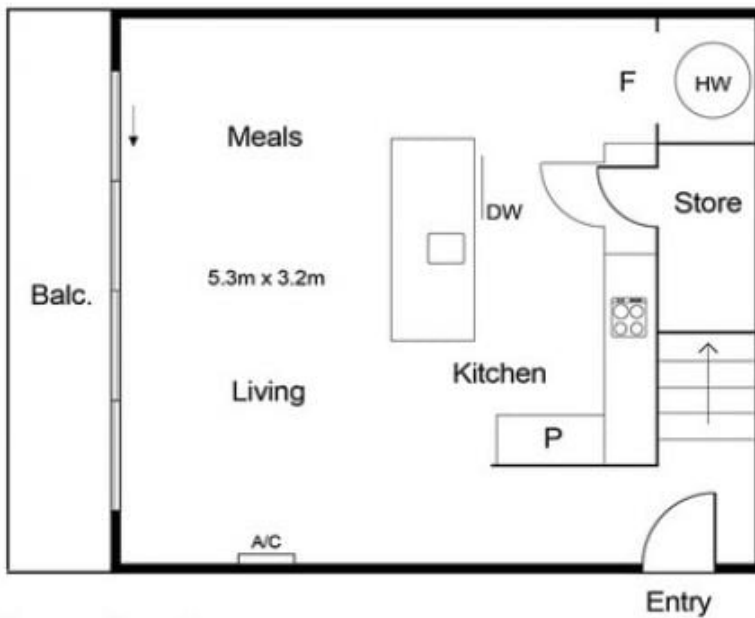
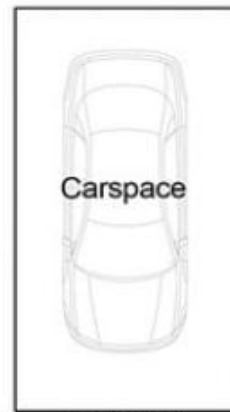

Lower Level

6/50 ROURKE LANE, KENSINGTON

Please note, plans are indicative only and not drawn to exact scale. Whilst every effort has been made to ensure the accuracy of this floor plan, no responsibility is taken for error, omission, or misstatement. Potential buyers should view the property in person.