



**214/108 Haines Street North Melbourne VIC**

1 1 1

Discover the ideal combination of modern style, serenity, and city-edge convenience just minutes from Melbourne's vibrant CBD.

Step into a welcoming open-plan kitchen, living, and dining area that's perfect for entertaining and relaxation. Equipped with reverse cycle split-system air conditioning, this home ensures year-round comfort. Slide open the glass doors to a covered balcony, your perfect spot for a morning coffee or evening wind-down.

The kitchen will delight any chef, featuring sleek cabinetry, high-quality finishes, and stainless-steel appliances, including a gas cooktop and dishwasher. Entertain with ease in this spacious, open-plan setting.

[For full version visit the website](https://www.jmre.com.au)

|                      |   |
|----------------------|---|
| <b>Type</b>          | : Unit  |
| <b>Price</b>         | : ESP \$410,000- \$450,000  |
| <b>Building Size</b> | : 68 sqm  |
| <b>View</b>          | : <a href="https://www.jmre.com.au/sale/vic/inner-city/north-melbourne/residential/unit/8187425">https://www.jmre.com.au/sale/vic/inner-city/north-melbourne/residential/unit/8187425</a> |



**Jmre A Smartre Agency**  
03 9328 2002

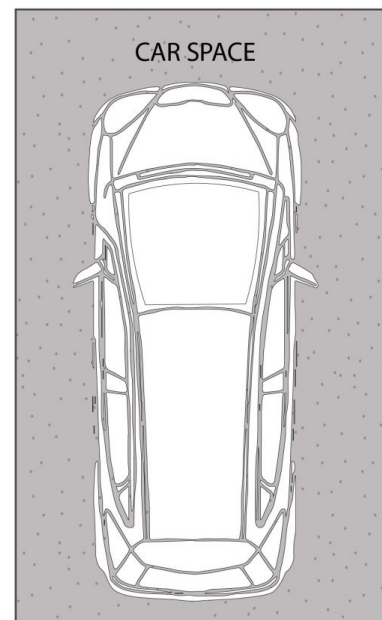
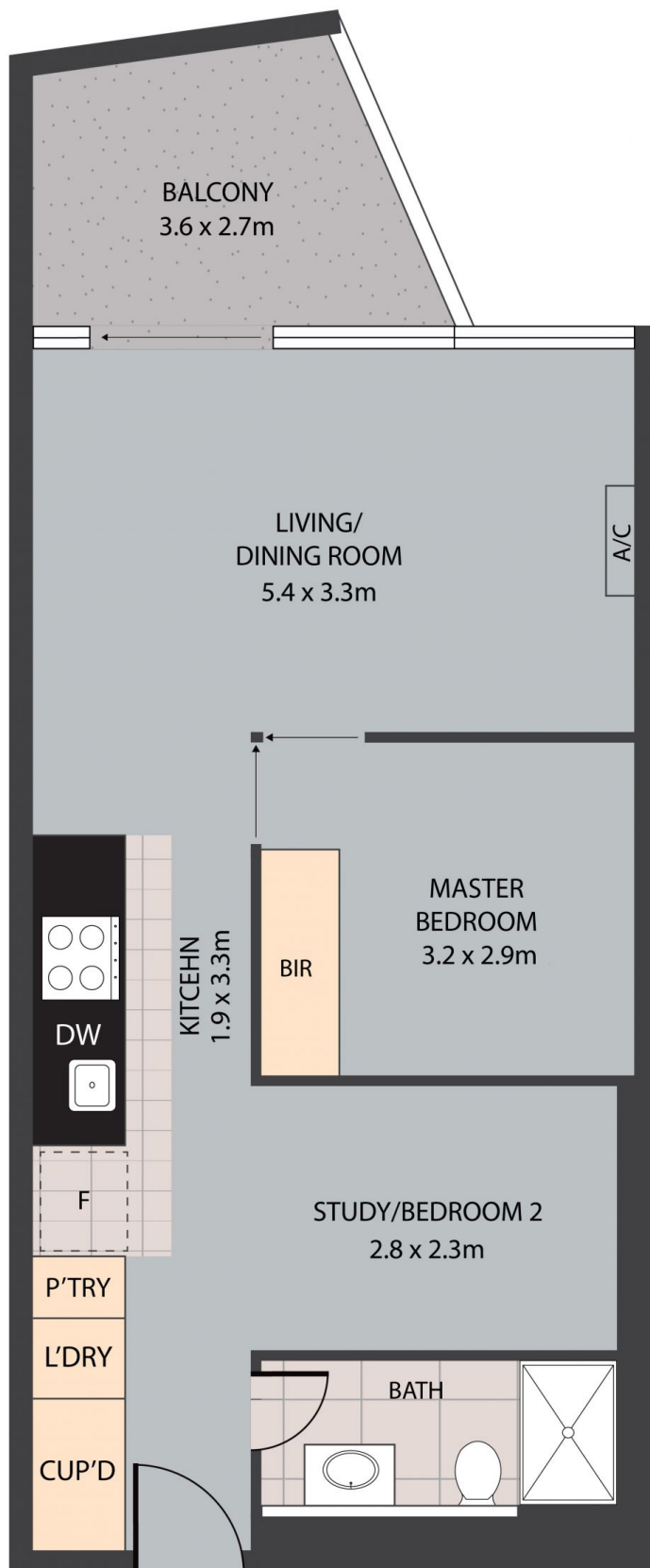

(NOT IN POSITION)

214/108 Haines Street, North Melbourne, VIC, 3051  
TOTAL APPROX. FLOOR AREA 68 SQ.M

Whilst every attempt has been made to ensure the accuracy of the floor plan contained here, measurements of doors, windows, rooms and any other items are approximate and no responsibility is taken for any error, omission, or misstatement. This plan is for illustrative purposes only and should be used as such by any prospective purchaser.