



207/253 Franklin Street Melbourne VIC

2 1

Discover this exceptional 2-bedroom apartment in the sought-after 'Infinity' complex, just steps from Flagstaff Gardens and Victoria Market. Offering generous space, abundant natural light, stunning views, and high-quality finishes, this apartment truly stands out.

Key features include:

Bright, spacious living room with a wall-mounted TV
Modern kitchen with stone benchtops, ample pantry space, and stainless steel appliances, including an electric oven, gas cooktop, and dishwasher
Main bedroom with built-in robes
Central luxurious bathroom conveniently located off the entry hall

Type : Apartment
Price : ESP \$370,000 - \$400,000
View : <https://www.jmre.com.au/sale/vic/inner-city/melbourne/residential/apartment/8188318>



Jmre A Smartre Agency
03 9328 2002

[For full version visit the website](https://www.jmre.com.au)

<https://www.jmre.com.au>

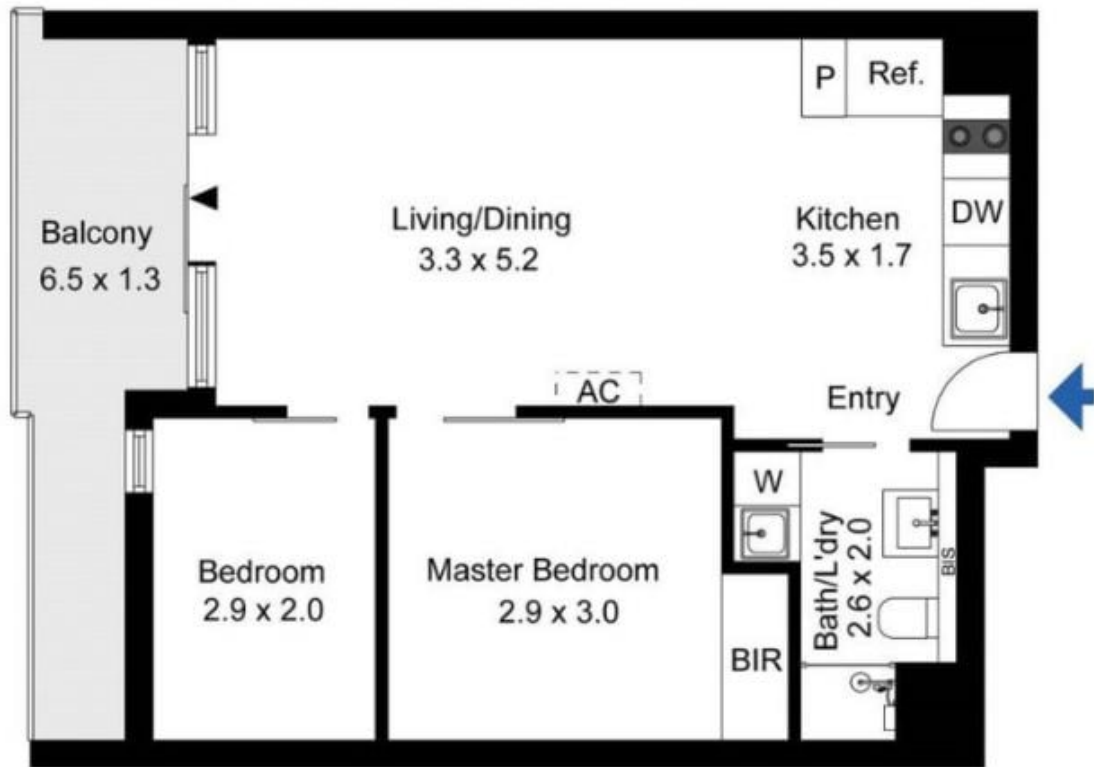

The site plan and floor plan are not to scale; measurements are indicative and in metres. Bushes and trees are placed for illustration purposes. Plans should not be relied on. Interested parties should make and rely on their own enquiries.



The floor plan is not to scale; measurements are indicative and in metres. All features included in this 3D plan are for inspiration purposes only. This is not an exact replica of the property or the position of exterior elements. Plans should not be relied on. Interested parties should make and rely on their own enquiries.

Produced by **DIAKRIT**
jmre
 a smartre agency